

swingo® 150 E

Preparation



Remove tank from machine by pulling the lever. Remove dosing cup by turning it to the left.



Fill solution tank with fresh water up to indicated mark. Label with mark is on solution tank side.



Dose cleaning product into dosing cup and pour into solution tank. Make sure dosing cup is exactly turned in.



Remount tank in machine until it locks into place and press the hook to lock tank.

Operation



Plug cable and press main switch to turn machine on. Switch will light up.



Hold machine firmly by the handle. Bring it to working position by pressing red foot pedal.



Adjust brush pressure by turning knob slowly anticlockwise until red light turns off. Red light indicates that motor is overloaded.

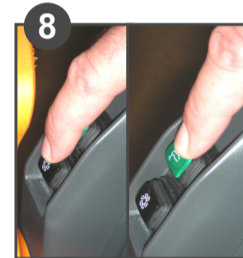

Press first suction switch (no lamp) and afterwards water pump switch (lamp lights up).

Maintenance

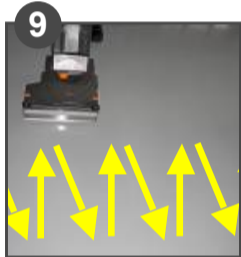

If red light goes on and o immediately while working, adjustment is correct. Cleaning can start following direction of arrows (picture).



Switch off water pump. Run suction unit for 10 seconds more to suck out remaining water. Switch off suction motor.

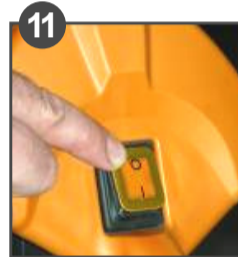

Switch machine off. Lock machine in vertical park position. Unplug cable. Always disconnect cable before any maintenance!



Remove tank from machine by pulling the hook. Unlock and remove filter housing.



Empty both tanks. Rinse and wash tank insides with room temperature water and a non-abrasive sponge.



Unhook transparent filter cover and remove filter. Wash filter under running water. Wring it out so that water can flow away.



Wash out whole filter housing and float under running room temperature water.



Do not remount filter before it is completely dry!



Hook filter housing in tank paying attention that front tooth is correctly inserted.

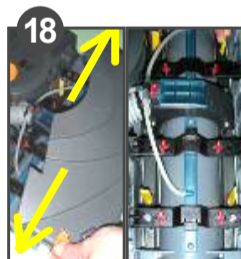

Remove brush housing cover by unsliding two side latches. Rotate yellow clips until they unhook to release squeegees.



Put machine on left side to remove squeegees. Wash squeegees under running room temperature water.



Check squeegee condition before reinstalling. Replace squeegees and note front & rear writing on squeegee top.

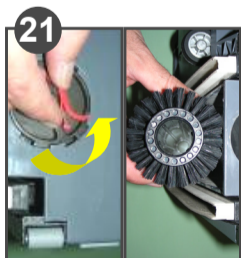

Press rotation lock, turn brush holder anticlockwise and pull it out. Push and remove brush roller to clean.



Clean brush housing using damp cloth.

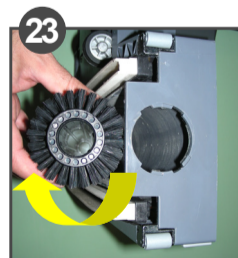

Check bristle length before reinstalling brush roller. Refit brush holder and turn it clockwise until lock latches into place.



Rotate yellow clip. Remove transparent converter cover. Check suction conveyor that it is free from debris. Remount cover and hook it.



Clean machine with moist cloth. Store machine with open tank for ventilation.

ATTENTION!

Do not use the machine before you have read and understood the operating instructions!
Questions: 1-800-558-2332

